

Fiber to Free Space High Power Isolator for Pulse Application-2μm

Specifications

Parameters		Unit	Non-PM Fiber (HPFIS)	PM Fiber (HPMFIS)
Center Wavelength		nm	1940, 1950, 1970, 2000, 2050	
Operating Bandwidth		nm	±30	
Insertion Loss		dB	≤0.5	
Isolation at 23°C(λc)		dB	≥28	
PDL		dB	≤0.15	---
Extinction Ratio		dB	---	≥20
Fiber Type @ input		---	SMF-28e, SM1950, SM2000	PM1550, PM1950, FUD-3716
Fiber Type @ output		---	Free Space	Free Space
Return Loss		dB	≥50	
Beam Roundness		%	≥90	
M ² Degradation		%	≤10	
Nominal Output Beam Diameter		mm	~5	
Power Handling	Average Optical Power	W	5, 10, 20, 50W	
	Peak Power for ns Pulse	kW	5, 10	
Operating Temperature		°C	10 ~ +60	
Storage Temperature		°C	-40 ~ +85	

Package Dimensions

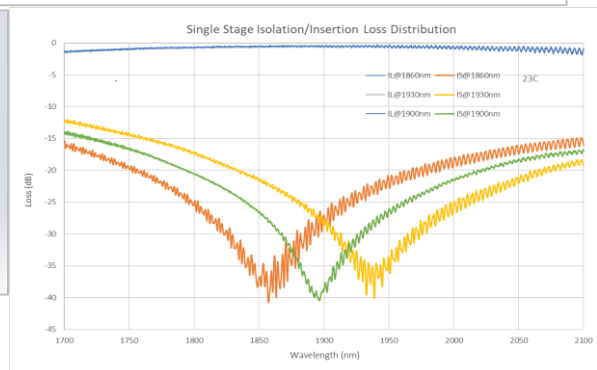
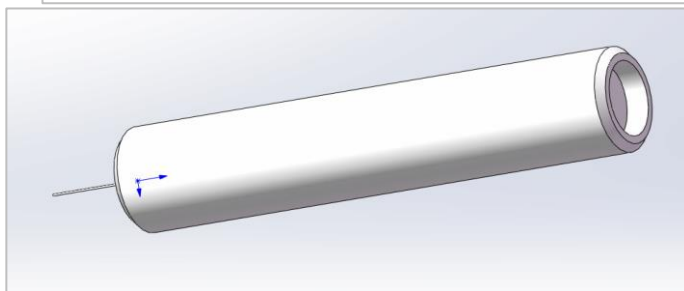
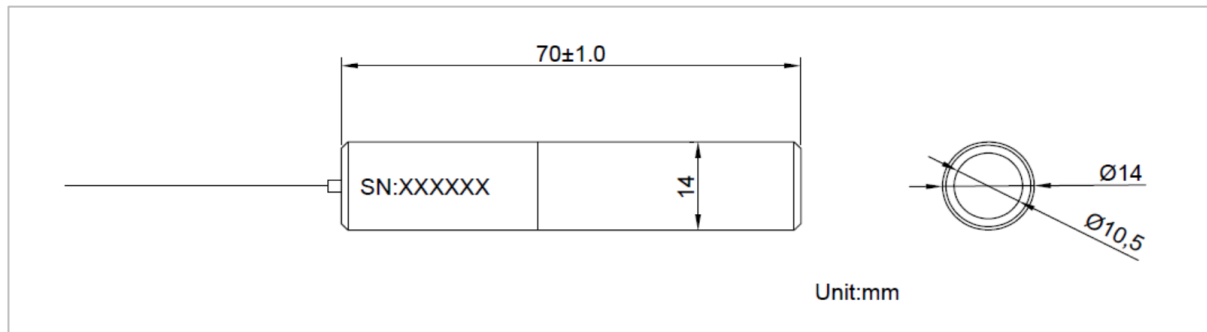

Ordering Information

HPFIS-
HPMFIS ①①①①-②-③③③-④-⑤-⑥⑥

①	Wavelength	1940; 1970; 1950; 2000; 2050;
②	Working Axis	1=Fast Axis Blocked; 2=Both Axis Pass;
③	Pigtail Type	250=250μm Fiber; 900=900μm Loose Tube; 3A=3mm Armoured;
④	Fiber Type	1=SMF-28e; S9=SM1950; 0=SM2000; 5=PM1550; P9=PM1950; P3=FUD-3716;
⑤	Fiber Length	1=1m;
⑥	Power Handling	5W; 10W, 20W; 50W;